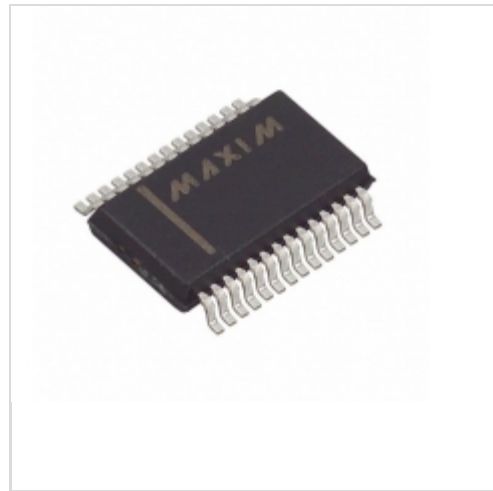

**MAX1491CAI+T**

**Maxim Integrated**

IC ADC W/LCD DRIVER 28-SSOP  
Lead free / RoHS Compliant  
Integrated Circuits (ICs)

- [1.MAX1491CAI+T.pdf](#)
- [2.MAX1491CAI+T.pdf](#)

Buy Now

part#MAX1491CAI+T is available, see description of MAX1491CAI+T as below .  
use the request quote form to request MAX1491CAI+T price and lead time.  
Buy Electronic Components at zeanoit.com .we are an independent distributor of electronic components with extensive inventory in stock.  
The price and lead time for MAX1491CAI+T depending on the quantity required, availability and warehouse location.Contact us today and our sales team will send you quotation soon.  
Email: sales@zeanoit.com

**Shopping Process**
**1**

Confirm the product

**2**

submit the order

**3**

payment

**4**

wait for delivery

**5**

receive the goods

**Specifications**

<b>Voltage - Supply:</b>	2.7 V ~ 5.25 V
<b>Supplier Device Package:</b>	28-SSOP
<b>Series:</b>	-
<b>Packaging:</b>	Tape & Reel (TR)
<b>Package / Case:</b>	28-SSOP (0.209", 5.30mm Width)
<b>Operating Temperature:</b>	0°C ~ 70°C
<b>Mounting Type:</b>	Surface Mount
<b>Interface:</b>	-
<b>Display Type:</b>	LCD
<b>Digits or Characters:</b>	A/D 3.5 Digits
<b>Current - Supply:</b>	980µA
<b>Configuration:</b>	7 Segment + 2 Annunciators

**Related products**

**MAX1492**  
in stock  
[MAXIM](#)

RFQ

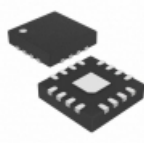

**MAX14914ATE+**  
IC SWITCH HIGH SIDE 16-TQFN  
[Maxim Integrated](#)

RFQ



**MAX1491CAI**  
in stock  
[MAXIM](#)

RFQ

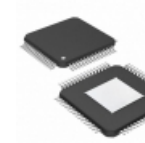

**MAX14920ECB+**  
IC AFE 12/16CELL MEASURE TQFP  
[Maxim Integrated](#)

RFQ



**MAX1491CNI**  
in stock  
[MAXIM](#)

RFQ



**MAX1491CNI+**  
IC ADC W/LCD DRIVER 28-DIP  
[Maxim Integrated](#)

RFQ



**MAX14914EVKIT#**  
EVAL FOR MAX14914  
[Maxim Integrated](#)

RFQ



**MAX14913EVKIT#**  
EV KIT FOR MAX14913  
[Maxim Integrated](#)

RFQ



**MAX14920ECB**  
[MAXIM](#)

RFQ



**MAX1491CAI+**  
IC ADC 3.5 DGT LCD DVR 28-SSOP  
[Maxim Integrated](#)

RFQ

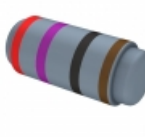
**Guess You May Looking For**

**MMP200FRF27R**  
RES SMD 27 OHM 1% 2W MELF  
[Yageo](#)

RFQ



**CRGH2512F562R**  
RES SMD 562 OHM 1% 2W 2512  
[TE Connectivity Passive Product](#)

RFQ



**AT1206CRD071K24L**  
RES SMD 1.24KOHM 0.25% 1/4W 1206  
[Yageo](#)

RFQ



**CRGH2512F95R3**  
RES SMD 95.3 OHM 1% 2W 2512  
[TE Connectivity Passive Product](#)

RFQ

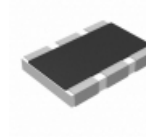

**AA1218JK-07240KL**  
RES SMD 240K OHM 1W 1812 WIDE  
[Yageo](#)

RFQ

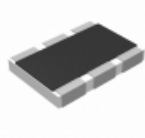

**AA1218JK-0736KL**  
RES SMD 36K OHM 1W 1812 WIDE  
[Yageo](#)

RFQ



**RT0805BRC07240KL**  
RES SMD 240K OHM 0.1% 1/8W 0805  
[Yageo](#)

RFQ



**RT1206BRE07105KL**  
RES SMD 105K OHM 0.1% 1/4W 1206  
[Yageo](#)

RFQ



**RT0603BRB0790K9L**  
RES SMD 90.9KOHM 0.1% 1/10W 0603  
[Yageo](#)

RFQ



**RNC2512DKE1R05**  
RES SMD 1.05 OHM 0.5% 1W 2512  
[Stackpole Electronics Inc.](#)

RFQ